

# BONE CRUSHER™

# 600

## FOOD WASTE DISPOSER



### 1/2 HP STANDARD

#### Easy and Fast to Install

Bone Crusher Bio Shield disposers feature Speed Master Mounting, an exclusive system that provides fast and economical installation.

#### Corrosion Proof

The Bone Crusher Bio Shield Standard model carries a lifetime warranty against failure due to corrosion.

#### Permanent Magnet Motors

Bone Crusher Bio Shield motors offer maximum torque instantly with the power to cut through potential jams.

#### Removable Splash Guard

All Bone Crusher Bio Shield models have a removable splash guard, ideal for easy cleaning and replacement.



#### BIO SHIELD

(Antimicrobial) for **ODOR PROTECTION!** Disposers are treated with an antimicrobial agent molded inside providing protection against odor causing bacteria growth.



#### The TORQUE MASTER Grinding System

is a combination of computer designed and balanced components working in unison to provide superior torque grind speed and long system life.

HORSEPOWER	1/2 HP
MOTOR SPEED RPM	2600 RPM
VOLTAGE	100v / 120v / 220-240v
AMPS	4.5 / 4.5 / 2.25
CYCLES	50/60
MOTOR TYPE	Permanent Magnet
SPLASH GUARD	EPDM Rubber
DRAIN OUTLET	Polycarbonate 940
GRIND RING	Stainless Steel
SWIVEL IMPELLERS	Stainless Steel
BALANCED TURNTABLE	Stainless Steel
BALANCED ARMATURE SHAFT	Stainless Steel

HOPPER	ABS
DRAIN HOUSING	Thermoset Polymer
APPLIANCE PROTECTOR	Manual Reset
SINK FLANGE	Polymide 66
STOPPER	Polypropylene
BEARINGS	Permanently Lubricated, Sleeve Type
SOUND SHELL	Partial

Dimensions	International	USA & Canada
INDIVIDUAL SHIPPING WEIGHT	4.4 KG	10.9 lb
MASTER CARTON WEIGHT (4 UNITS)	18.6 KG	49 lb
MEASUREMENT A	354 MM	13.9"
MEASUREMENT B	161 MM	6.3"
MEASUREMENT C	132 MM	5.2"
MEASUREMENT D	137 MM White Elbow / 140 MM Black Elbow	5.5"
MEASUREMENT E	70 MM White Elbow / 100 MM Black Elbow	3.9"
LIFETIME CORROSION GUARANTEE	Yes	Yes

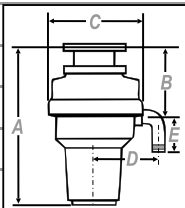

(International Market- Outside of USA & Canada)

**Anaheim Marketing International**

4332 E. La Palma Avenue, Anaheim, California 92807

Telephone: 714.993.1707 Fax: 714.993.1930 Website: www.AnaheimMarketing.com

Email: ContactUs@AnaheimMarketing.com



(USA & Canada)

**Joneca Corporation**

4332 E. La Palma Avenue, Anaheim, California 92807

Telephone: 714.993.5997 Fax: 714.993.2126 Toll Free 1-888-8Joneca

Website: www.Joneca.com Email: ContactUs@Joneca.com